

TTI Model Number: 018 156 025

Starting Serial Number:

M18™ FUEL 100MM BRAKING GRINDER

VERSION A - D2018

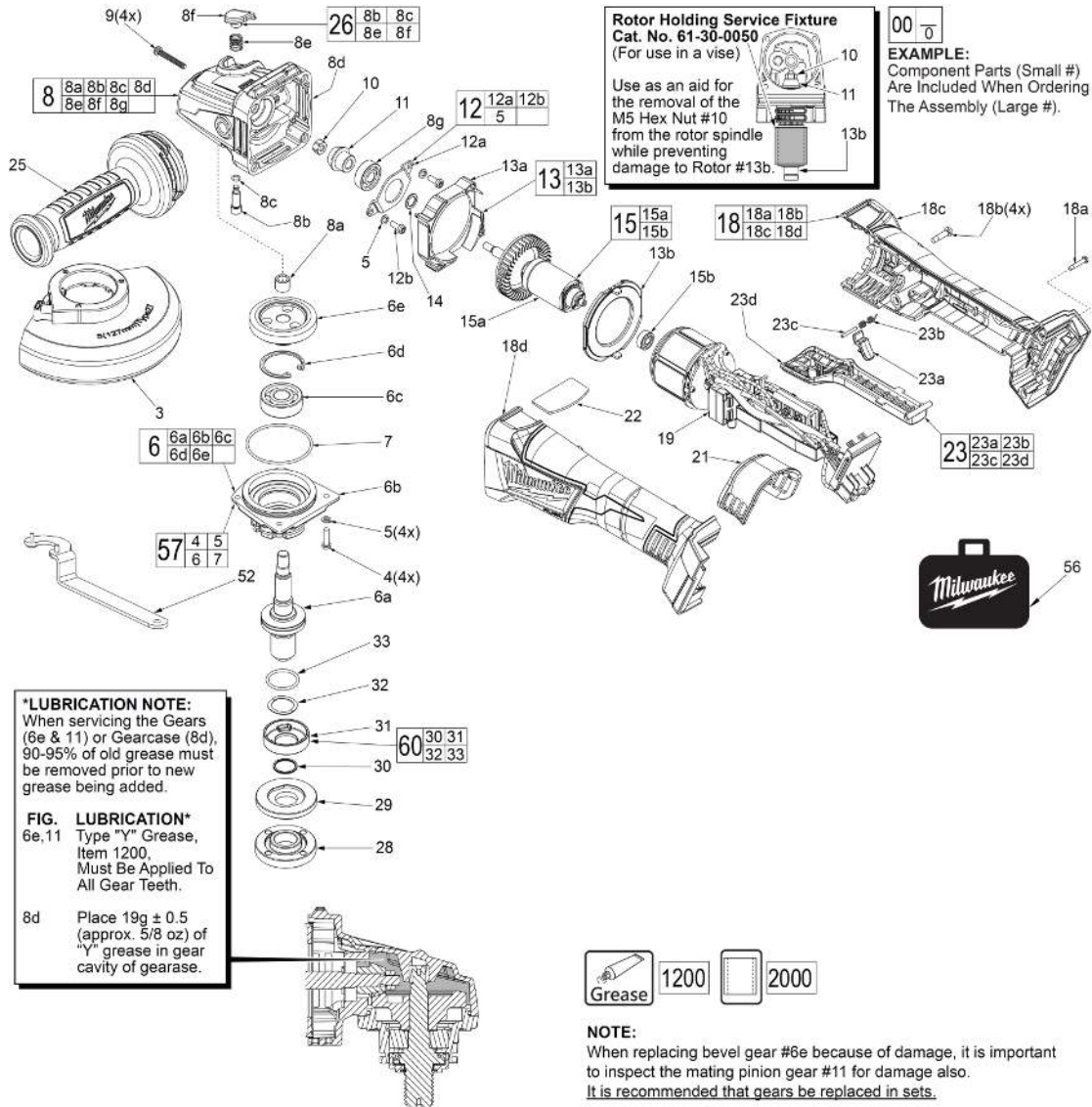



M18 CAG100XPDB

SERVICE PARTS LIST

Bulletin Date:

Mar-18

TTI Model Number: 018 156 025

Starting Serial Number:

M18™ FUEL 100MM BRAKING GRINDER

VERSION A - D2018

| ITEM | PART NUMBER | PART DISCRIPTION | QTY (PCS) |
|------|-------------|----------------------------------|-----------|
| 3 | 201647011 | 4" TYPE 27 GUARD ASSEMBLY | 1 |
| 4 | 660414013 | M4x14MM SCREW | 4 |
| 5 | 680866003 | SPRING WASHER | 6 |
| 6 | 202610004 | SPINDLE HUB ASSEMBLY | 1 |
| 6a | - | OUTPUT SHAFT | 1 |
| 6b | - | SPINDLE HUB | 1 |
| 6c | - | BALL BEARING | 1 |
| 6d | - | RETAINING RING | 1 |
| 6e | - | BEVEL GEAR | 1 |
| 7 | 562584001 | O-RING | 1 |
| 8 | 202611003 | GEAR CASE ASSEMBLY | 1 |
| 8a | - | NEEDLE BEARING | 1 |
| 8b | - | SPINDLE LOCK PIN | 1 |
| 8c | - | O-RING | 1 |
| 8d | - | GEAR CASE | 1 |
| 8e | - | SPINDLE LOCK SPRING | 1 |
| 8f | - | SPINDLE LOCK BUTTON | 1 |
| 8g | - | BALL BEARING | 1 |
| 9 | 660024035 | M4x28MM SCREW | 4 |
| 10 | 671686001 | M5 HEX NUT | 1 |
| 11 | 613496001 | PINION GEAR | 1 |
| 12 | 202615001 | BEARING RETAINING PLATE ASSEMBLY | 1 |
| 12a | 672569001 | BEARING RATAINER | 1 |
| 12b | 660400005 | M4x10MM SCREW | 2 |
| 13 | 202614001 | BAFFLE ASSEMBLY | 1 |
| 13a | - | FAN BAFFLE | 1 |
| 13b | - | FAN BAFFLE FOOT | 1 |
| 14 | 632876001 | WASHER | 1 |
| 15 | 202616001 | ROTOR ASSEMBLY | 1 |
| 15a | - | ROTOR | 1 |
| 15b | 681366001 | BALL BEARING | 1 |
| 18 | 203676001 | HOUSING KIT | 1 |



M18 CAG100XPDB

SERVICE PARTS LIST

TTI Model Number: 018 156 025

M18™ FUEL 100MM BRAKING GRINDER

Bulletin Date:

Mar-18

Starting Serial Number:

VERSION A - D2018

| ITEM | PART NUMBER | PART DISCRIPTION | QTY (PCS) |
|------|-------------|-------------------------------|-----------|
| 18b | 660024030 | M4x16MM SCREW | 4 |
| 18a | 660274003 | 4-20x5/8" SCREW | 1 |
| 18c | - | HANDLE COVER - RIGHT | 1 |
| 18d | - | HANDLE SUPPORT - LEFT | 1 |
| 19 | 203683001 | ELECTRONICS ASSEMBLY | 1 |
| 21 | 305952001 | DUST COVER | 1 |
| 22 | 351784001 | LOGO PLATE | 1 |
| 23 | 203581001 | PADDLE TRIGGER ASSEMBLY | 1 |
| 23a | - | LOCK-OFF LEVEL | 1 |
| 23b | - | LOCK-OFF SPRING | 1 |
| 23c | - | LOCK-OFF PIN | 1 |
| 23d | - | PADDLE TRIGGER | 1 |
| 25 | 304057001 | SIDE HANDLE ASSEMBLY | 1 |
| 26 | 202617001 | SPINDLE LOCK KIT | 1 |
| 27 | 941048386 | SERVICE NAMEPLATE (NOT SHOWN) | 1 |
| 28 | 672568014 | FLANGE NUT | 1 |
| 29 | 673448001 | FLANGE DISC,100x16MM | 1 |
| 30 | 672991002 | FLANGE WITH RAMPS | 1 |
| 31 | 633400002 | RATAINING RING | 1 |
| 32 | 633475002 | WAVE WASHER | 1 |
| 33 | 562518001 | O-RING | 1 |
| 52 | 632145003 | SPANNER WRENCH | 1 |
| 56 | 307640029 | BLOW MOLDED CARRYING CASE | 1 |
| 57 | 202610004 | SPINDLE HUB ASSEMBLY | 1 |
| 60 | 201767003 | FLANGE WITH RAMPS ASSEMBLY | 1 |
| 1200 | - | TYPE Y GREASE | 1 |
| 2000 | 61-30-0050 | ROTOR HOLDING SERVICE FIXTURE | 1 |

WIRE ROUTING AND TRAPPING
for the **ELECTRONICS KIT** in the
HANDLE SUPPORT (Left Handle Halve)

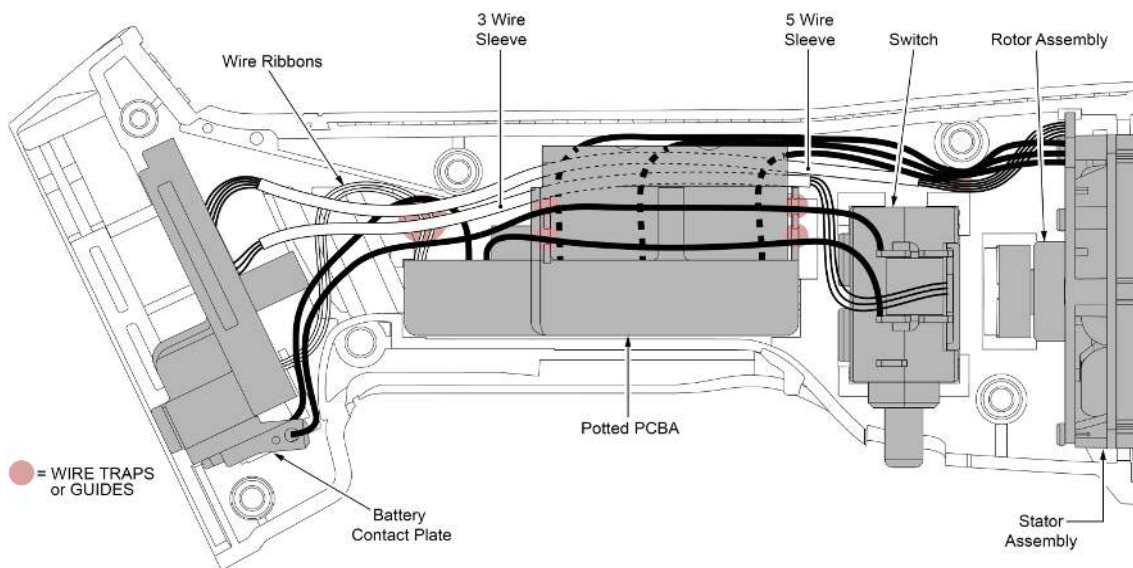

AS AN AID TO REASSEMBLY, TAKE NOTICE OF WIRE ROUTING AND POSITION IN WIRE GUIDES AND TRAPS WHILE DISMANTLING TOOL.

BE SURE THAT ALL COMPONENTS OF THE ELECTRONICS KIT ARE SEATED FIRMLY AND SQUARELY IN THE HANDLE RECESSES.

AVOID PINCHED WIRES, BE SURE THAT ALL WIRES AND SLEEVES ARE PRESSED COMPLETELY DOWN IN WIRE GUIDES AND TRAPS.

PRIOR TO INSTALLING THE HANDLE COVER ONTO THE HANDLE SUPPORT, BE SURE THAT THERE ARE NO INTERFERENCES.

SCREW TORQUE SPECIFICATIONS

| FIG. | PART NO. | WHERE USED | SEAT TORQUE | |
|------|-----------|----------------------|-------------|-----------|
| | | | (KG/CM) | (Nm) |
| 4 | 660414013 | Spindle Hub Assembly | 20-26 | 1.92-2.49 |
| 9 | 660024035 | Gear Case | 13-19 | 1.24-1.81 |
| 10 | 671686001 | Pinion Gear | 100 | 9.72 |
| 18a | 660274003 | Housing Kit | 13-19 | 1.24-1.81 |
| 18b | 660024030 | Housing Kit | 6-12 | 0.57-1.13 |